



EXCLUSIVE LISTING LANDMARK PROPERTY OFFICE FOR LEASE

(856) 985-9522 • ROSECOMMERCIAL.COM

67 N. MAIN STREET, MEDFORD, NJ



Property Description:

Building Size:

Landmark Retail / Office Property
~~8,895 +/- SF - 1st Floor Retail Fully Leased~~
3,500 +/- SF - Second Floor Office
860 +/- SF - Third Floor Office

13,255 +/- SF Total

Available:

4,360 +/- SF Office

Lease Rate:

\$14.00/ SF Plus Utilities

Comments:

- Prominent Building on Historic Main Street in Medford Village
- Exclusive new Retail / Office development opportunity
- Join Harvest Coffee, Whole Hog and local brewery and other retailers
- Over 50+ parking spaces

Adam Rose (Ext. 22)
arose@rosecommercial.com
(856) 985-9522

Jeffrey Lucas (Ext. 32)
jeffreylucas@me.com
(609) 254-1832

Rose Commercial Real Estate is a full service commercial real estate firm, specializing in all facets of the industry ~ representing buyers and sellers, landlords and tenants as well as investors both big and small. Key to our growth is experience combined with in depth understanding of the South Jersey real estate market. But that alone is only a part of the comprehensive service we provide clients. With our unique **CIRCLES FOR SUCCESS** and start-to-finish commitment, we make things happen.

651 Route 73 North, Suite 111 • Marlton, NJ 08053 • Phone: (856) 985-9522 • Fax: (856) 985-9488

ROSECOMMERCIAL.COM



EXCLUSIVE LISTING LANDMARK PROPERTY OFFICE FOR LEASE

(856) 985-9522 • ROSECOMMERCIAL.COM

67 N. MAIN STREET, MEDFORD, NJ

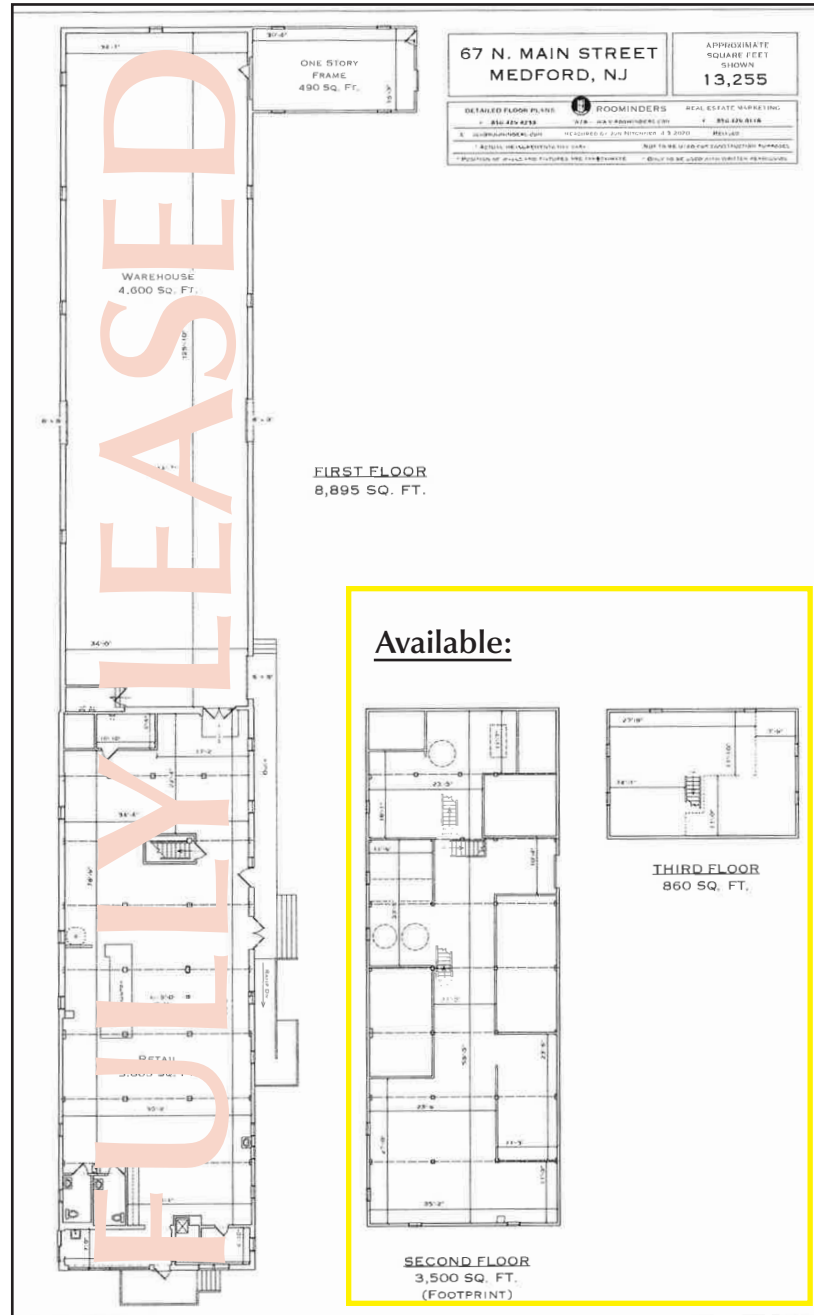

Rose Commercial Real Estate is a full service commercial real estate firm, specializing in all facets of the industry ~ representing buyers and sellers, landlords and tenants as well as investors both big and small. Key to our growth is experience combined with in depth understanding of the South Jersey real estate market. But that alone is only a part of the comprehensive service we provide clients. With our unique **CIRCLES FOR SUCCESS** and start-to-finish commitment, we make things happen.

651 Route 73 North, Suite 111 • Marlton, NJ 08053 • Phone: (856) 985-9522 • Fax: (856) 985-9488

ROSECOMMERCIAL.COM