

NEW JERSEY STATE HIGHWAY ROUTE 38
(VARIABLE ROW)

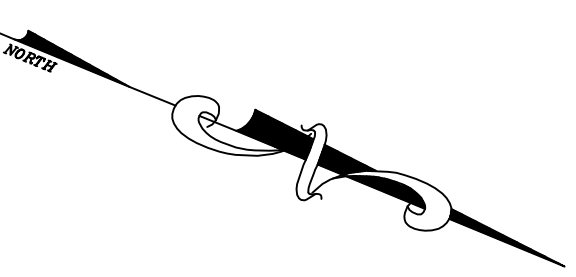
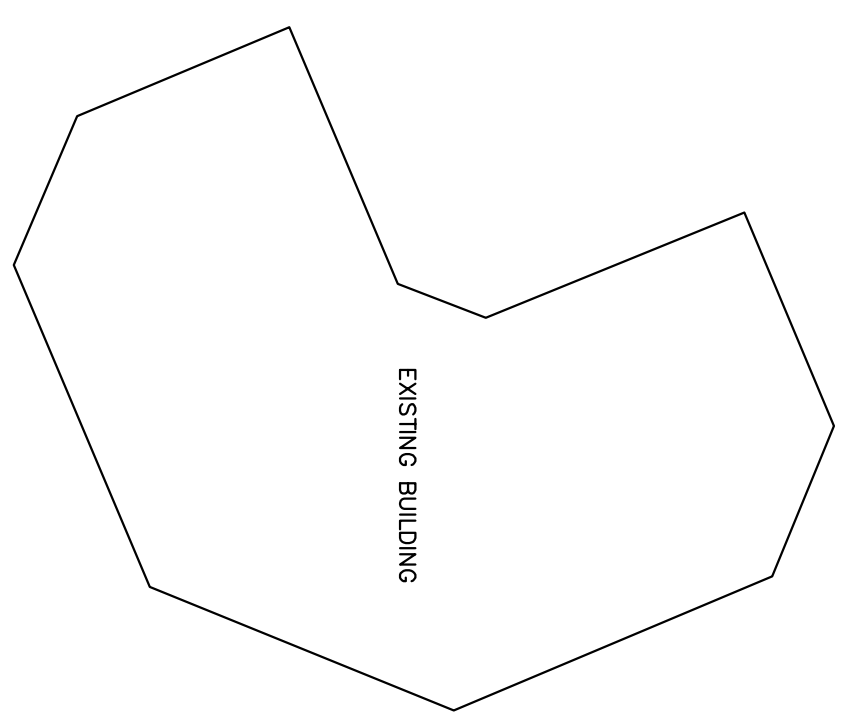

MIDLANTIC DRIVE
(VARIABLE ROW)

NUSH ROUTE 38 RAMP

MARTER AVENUE
(71.75' ROW)

SITE DATA:

1. PROPERTY KNOWN AS BLOCK 515 LOT 1
2. TRACT SIZE = 435,767 SF (10 ACRES)
3. GREEN SPACE = ~232,560 SF (5.3 ACRES) (53%)
4. EXISTING STORMWATER BASIN AREA = ~63,716 SF (1.5 ACRES)
5. LAND PLAN DESIGN CRITERIA:
 - 30' PERIMETER BUFFER
 - 25' WIDE INTERIOR ROADWAYS
 - PARKING STALL SIZE: 10 FT X 20 FT

PROPOSED PROJECT

HOTEL:
4-STORIES (16,250 SF FOOTPRINT; 65,000 SF GFA)
OUTDOOR POOL
130 ROOMS
PARKING: 1 STALL PER ROOM + 20 EMPLOYEES = 150 PARKING SPACES REQUIRED

RESTAURANTS:
TWO 5,000 SF RESTAURANTS
130 SEATS EACH
PARKING: 1 STALL / 2 SEATS + 10 EMPLOYEES = 75 PARKING SPACES EACH REQUIRED

TOTAL PARKING REQUIRED: 306
TOTAL PARKING PROPOSED: 306

ZONING SCHEDULE:

REQUIRED	PROPOSED
2 ACRES	10 ACRES (435,767 SF)
50%	6%
90%	47%
MAX. BUILDING AREA	110 FT
MAX. IMPERVIOUS COVERAGE	4-STORY, 66 FT
MAX. BUILDING HEIGHT	50 FT
FRONT YARD	50 FT
REAR YARD	N/A
SIDE YARD	50 FT (AT STREET)
	20 FT (NORM.)
	50 FT (AGGREGATE)
PAVED/IMPROVED FRONT YARD	30 FT
PAVED/IMPROVED REAR YARD	30 FT
DISTANCE FROM MCD LINE	75 FT
WIDTH AT MAIN BUILDING	100 FT
FRONTAGE	961 FT

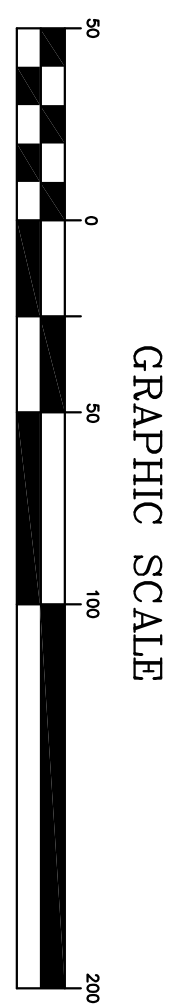

DESIGNED BY CECILIA BYRNE- SCHMIDT	DRAWN BY MAD	CHECKED BY REVISIONS	DATE
DRAFT			
CONCEPTUAL LAYOUT PLAN B			
BLOCK 515 LOT 1 MOUNT LAUREL TOWNSHIP BURLINGTON COUNTY, NEW JERSEY			
Taylor Wiseman & Taylor ENGINEERS / SURVEYORS / SCIENTISTS			
124 Galilee Drive, Suite 150, Mt. Laurel, NJ 08054 TELEPHONE: (856) 237-7200 FAX: (856) 722-9250 NJ CERTIFICATE OF AUTHORIZATION NO. 24C240303000			
SCALE: 1"=50'	DATE: 9/20/10	PROJECT NO.	SHEET: 1 OF 1